

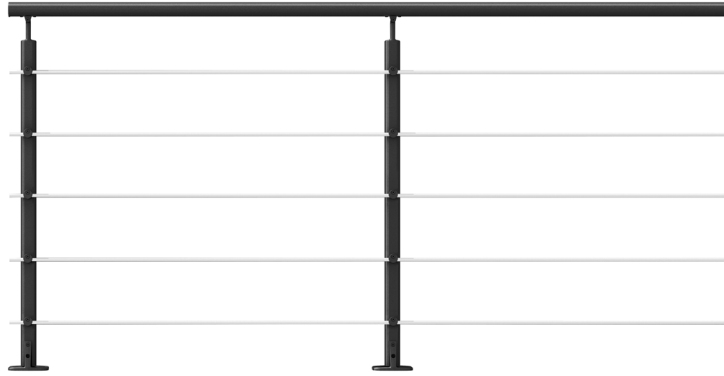

**MADE IN FRANCE**



## COMPOSITION DU PACK

5 tubes + 10 supports de tube + 20 manchons (accessoires de fixation pour panneau verre synthétique tous 2 vendus séparément, (ref.VA470 + ref.1869) - tubes recoupables  
1 main courante + 2 supports main courante + 2 embouts de finition  
2 poteaux + 2 finitions poteau  
2 platines au sol  
quincaillerie

## PACK CONTENT

5 tubes + 10 tube supports + 20 muffs (fitting accessories for optional acrylic glass panel bath sold separately, (ref.VA470 + ref.1869) - cuttable tubes  
1 handrail + 2 handrail brackets + 2 end caps  
2 posts + 2 post finishing  
2 post foot  
hardware

## CARACTÉRISTIQUES TECHNIQUES SPECIFICATIONS

### DIMENSIONS

hors tout overall	main courante handrail	poteaux posts	support poteau au sol post foot	tubes tubes
L 2006mm x H 1005 mm	Ø 40 2000 mm (x1)	70 x 110 x 972 mm (x2)	110 x 70 mm	Ø 10 x 2000 mm (x5)

### UTILISATION USE

intérieure  
indoor  
extérieure  
outdoor

### MATIÈRE MATERIAL

poteaux - main courante - embouts de finition - support de poteau  
posts - handrail - endcaps - post bracket

aluminium

tubes  
tubes

aluminium

quincaillerie  
hardware

acier inox A2  
A2 stainless steel

### TRAITEMENT FINITION

thermolaquage RAL7021  
powder coating RAL7021

anodisé incolore  
colorless anodized

-

### CERTIFICATION

-

-

-

### PROVENANCE ORIGIN

France

France

France

## GARANTIE 2 ANS WARRANTY 2 YEARS

## LOGISTIQUE - LOGISTIC

### LOGISTIQUE - LOGISTIC

gencod	conditionnement packaging	poids unité de vente weight unit sale
3 443 440 011 422	1	8 kg

### COLIS - PACKAGE

type	poids weight	longueur length	profondeur depth	hauteur height
carton	8 kg	205	12	7,5



## CONSEILS INSTALLATION INSTALLATION ADVICE

Règlementation: L'entraxe poteaux ne doit pas dépasser 1000mm, accessoires de fixation au sol non inclus, à choisir selon la nature du sol.  
Regulation: The space between posts must not exceed 1000mm, floor mounting kits no included, to be selected according to the type of floor.



**MADE IN FRANCE**

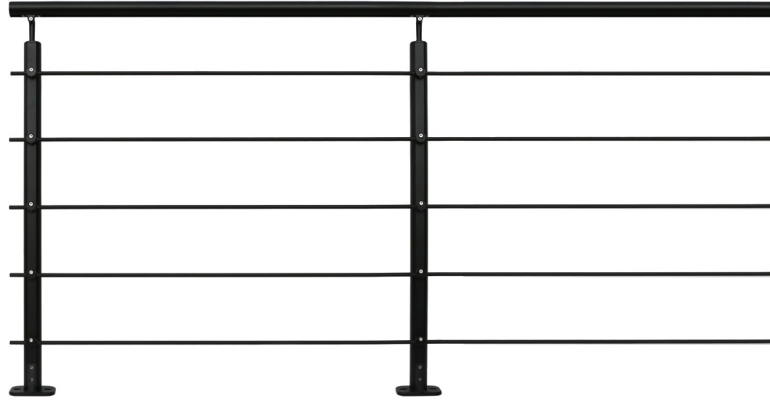

## COMPOSITION DU KIT

5 tubes + 10 supports de tube - tubes recoupables  
1 main courante (recoupable) + 2 supports main courante + 2 embouts de finition  
2 poteaux + 2 finitions poteau  
2 platines fixation à plat  
quincaillerie

## KIT CONTENT

5 tubes + 10 tube supports - cuttable tubes  
1 handrail (cuttable) + 2 handrail brackets + 2 end caps  
2 posts + 2 post finishing  
2 posts fixed to the floor  
hardware

## CARACTÉRISTIQUES TECHNIQUES SPECIFICATIONS

### DIMENSIONS

hors tout overall	main courante handrail	poteaux posts	support poteau au sol post foot	tubes tubes
L 2006 x H 1005 mm	Ø 40 x 2000 mm (x1)	Ø 43 x H 972 mm (x2)	110 x 70 mm	Ø 10 x 2000 mm (x5)

### UTILISATION USE

intérieure indoor  
extérieure outdoor

### MATIÈRE MATERIAL

poteaux - main courante - embouts de finition - support de poteau  
posts - handrail - endcaps - post bracket

aluminium

### TRAITEMENT FINITION

thermolaquage RAL9005  
powder coating RAL9005

### CERTIFICATION

-

### PROVENANCE ORIGIN

France

tubes  
tubes

aluminium

anodisé noir  
black anodized

-

France

quincaillerie  
hardware

acier inox A2  
A2 stainless steel

-

-

France

## GARANTIE 2 ANS WARRANTY 2 YEARS

## LOGISTIQUE - LOGISTIC

### LOGISTIQUE - LOGISTIC

gencod	conditionnement packaging	poids unité de vente weight unit sale
3 443 440 018 667	1	8 kg

### COLIS - PACKAGE

type	poids weight	longueur length	profondeur depth	hauteur height
carton	8 kg	205	12	7,5

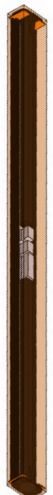

## CONSEILS INSTALLATION INSTALLATION ADVICE

Adaptez votre garde corps aux normes, pour une hauteur de chute supérieure à 1 m, usage privé & public NF P 01-012 / NF P 01-013 :

Panneau transparent de protection, à fixer sur la partie basse du garde corps (réf. VA470) + support (réf. 1869)

Règlementation: l'entraxe poteaux ne doit pas dépasser 1000 mm, accessoires de fixation inclus hors fixation au sol, à choisir selon la nature du sol.

Adapt your handrail to the standard for a fall height over 1 m, for private & public use NF P 01-012 / NF P 01-013 :

Transparent panel for lowel protection, to fix to the bottom of the railing (ref. VA470) + support (réf. 1869)

Regulation: the space between each spindle must not exceed 1000 mm, mounting accessories included excluding floor mounting kits, to be selected according to the type of floor.